



MEMORANDUM

To: Mayor and City Council
 From: Jeff Downes
 City Manager
 Date: April 8, 2020
 Re: Community Engagement Process - Playground Equipment

As you are aware from previous communications, the City and its program partners unveiled a draft version of playground designs for both Wald Park and Cahaba Heights Park in March. Following in-person and virtual engagement with the public, we were able to gather objective data on the desires of the community. Our process included three public meetings and institution of a Vestavia Hills Listens survey. Approximately 300 residents provided input as a part of these four engagements. Summarized below are the top desires of the community as per the survey findings. These are in line with the input gathered in the three public meetings. For a more detailed review, the complete executive summary and actual survey results are attached.

Summary of Results - Wald Park and Cahaba Heights Park Playground Survey				
<i>RANKED BY PERCENTAGE OF IMPORTANCE- Very/Somewhat Important</i>				
Description of Amenity	No of Very and Somewhat Important Responses	No of Responses for Question	Percentage of Importance	
Restrooms	257	263	97.72%	
Shade	256	263	97.34%	
Swings	248	263	94.30%	
Seating (Benches)	235	263	89.35%	
Slides	235	263	89.35%	

Top Five Amenities by Respondent		
<i>Ranked by No Included in Top Five</i>		
Description of Amenity	No Included in Top Five	Percentage
Shade	194	15.99%
Restrooms	148	12.20%
Swings	137	11.29%
Fencing/Security	124	10.22%
Seating (Benches)	107	8.82%

The initial playground design attempted to offer a broad set of activities in an inclusive and safe manner all within the original budget of approximately \$750,000. Upon receipt of the input provided above, the design team has presented a couple of additional options to address these publicly endorsed priorities. Furthermore, the additional cost associated with these options have been quantified. In the pages to follow you will find the financial implications of the changed design as well as the visuals associated with these changes. Outside of this memorandum, I will be discussing the means with which we might absorb the additional costs. We have scheduled a Council work session at 5pm on April 13, 2020 to discuss these changes. While options are presented, many combinations of choices may be considered in your decision-making process. Please let me know if you need any additional information or materials prior to the work session.

Playground Budget Options			
	Option 1	Option 2	Option 3
Wald Upper	\$366,962	\$433,055	\$470,791
Wald Lower	\$235,983	\$276,640	\$276,640 (Op 2)
Wald Fitness	\$28,852	\$28,852 (Op 1)	\$28,852 (Op 1)
Cahaba Heights	\$109,677	\$138,556	\$138,556 (Op 2)
Total	\$741,474	\$877,103	\$914,839
<i>Difference from Option One</i>		\$135,629	\$173,365

These options include the following priorities:

- Addition of **shade** at all three playgrounds
 - Total additional shade of 2,495 square feet
- **Restrooms** remain a part of the original plan at all sites.
- **Swings** are added to Upper Wald and Cahaba Heights playgrounds. They also remain a part of the Lower Wald playground.
 - Upper Wald- Eight swings added
 - Cahaba Heights- Four swings added and playground site increased by 475 feet to accommodate the additional swings
- Additional **seating/benches** added to the Lower Wald and Cahaba Heights playgrounds.
 - Seating/benches remain a part of the Upper Wald playground.
- **Slides** remain as a critical element to all playgrounds.
- Upper Wald playground added **play equipment** that has additional **inclusive** benefit.
- Option three includes a 19-feature **timber tower** that has similarities to features included in the former “Castle Park”.
- Various **fencing, “bench walls” and natural barriers** remain a part of the plan.

I have included, on the following pages, low resolution images of the redesigned playgrounds. If you would like to view higher resolution images, they can be accessed at:

<http://ddeck.io/5e7e4a1a167c280014e17dbf>

I look forward to further conversation at the Council work session and will be asking Cinnamon to publicize this memo after our discussion on Monday.

WALD PARK UPPER PLAYGROUND OPTIONS



UPPER PLAYGROUND OPTION 2

- Added 1,220 square feet of shade
- Replaced Saucer Swing with 2 traditional belt swings, 2 tandem belt swings, and 2 toddler bucket seats (8 swing seats total)
- Added Agility Pods for obstacle course element
- Added Infinity Bowl for spinning element with inclusive benefit







UPPER PLAYGROUND OPTION 3

- Includes all additions of Option 2, plus:
- Replaced Modern Tower play structure with Timber Tower. The Timber Tower has 19 total activities within the play structure including more bridges, tunnels, under-deck activities, and dramatic play opportunities similar to the former Castle Playground. The Timber Tower doubles the number of activities included on the Modern Tower in Option 2.



WALD PARK LOWER PLAYGROUND OPTIONS

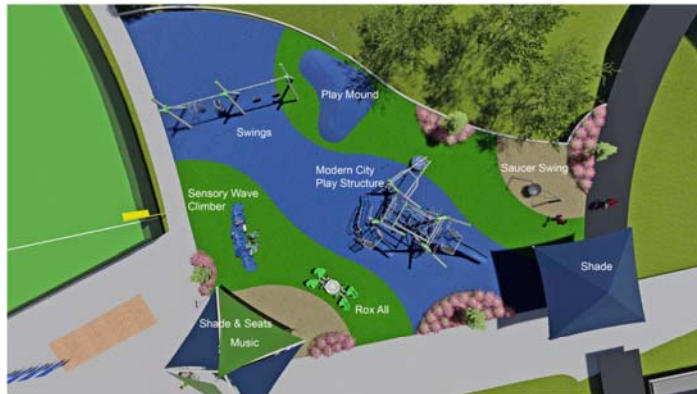
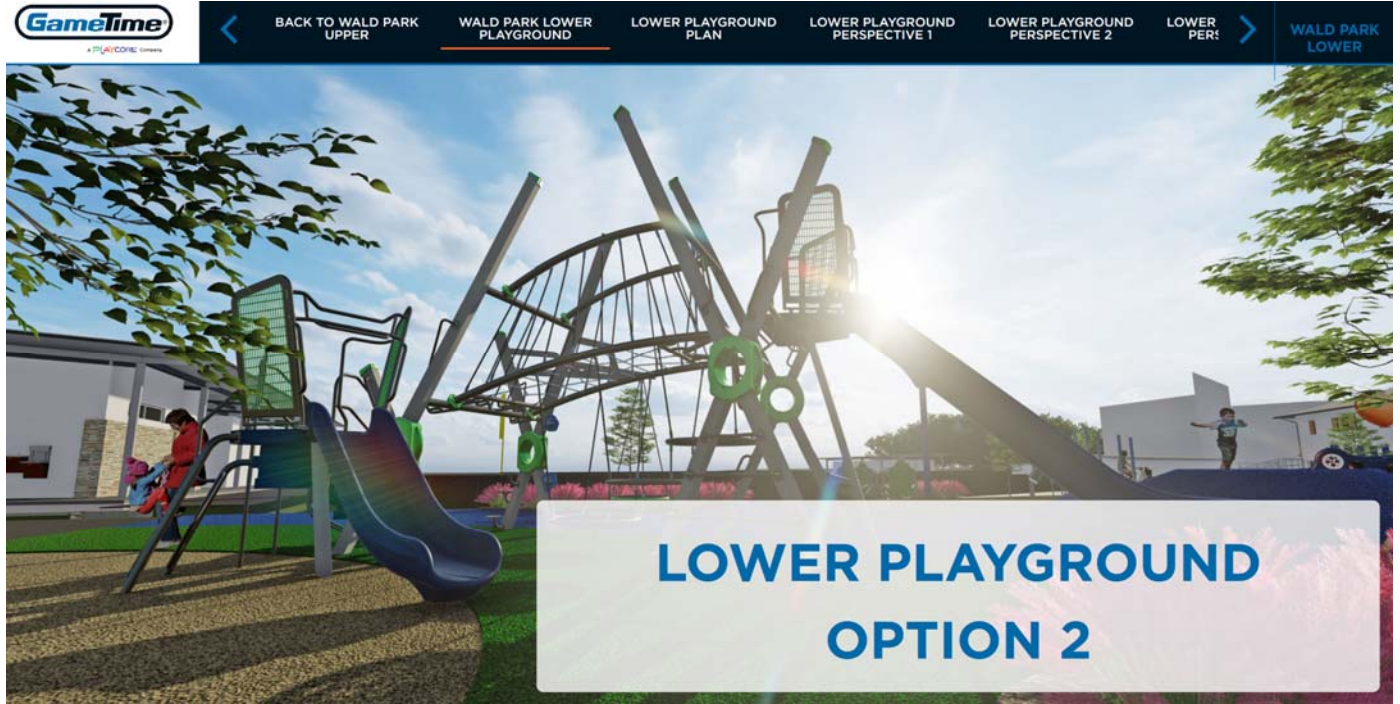

LOWER PLAYGROUND OPTION 2

- Adds 800 square feet of shade
- Adds additional seating under shade
- Relocates Saucer Swing from Upper Playground to Lower Playground





LOWER
GROUND

LOWER PLAYGROUND
PLAN

LOWER PLAYGROUND
PERSPECTIVE 1

LOWER PLAYGROUND
PERSPECTIVE 2

LOWER PLAYGROUND
PERSPECTIVE 3

LOWER PLAYGROUND
PERSPECTIVE 4



WALD PARK
LOWER



GROUND
N

LOWER PLAYGROUND
PERSPECTIVE 1

LOWER PLAYGROUND
PERSPECTIVE 2

LOWER PLAYGROUND
PERSPECTIVE 3

LOWER PLAYGROUND
PERSPECTIVE 4

LOWER PLAYGROUND
PERSPECTIVE 5



WALD PARK
LOWER





GROUND
TIVE 1

LOWER PLAYGROUND
PERSPECTIVE 2

LOWER PLAYGROUND
PERSPECTIVE 3

LOWER PLAYGROUND
PERSPECTIVE 4

LOWER PLAYGROUND
PERSPECTIVE 5

CONTINUE TO CAHAB/
HEIGHTS



WALD PARK
LOWER



CAHABA HEIGHTS PLAYGROUND OPTIONS

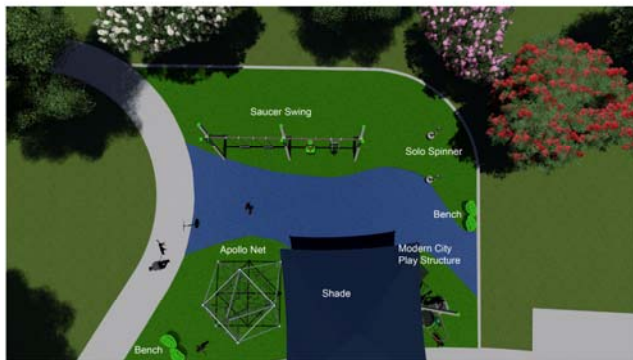

CAHABA HEIGHTS OPTION 2

- Added 400 square feet of shade
- Added 2 benches
- Replaced the Saucer Swing with 2 traditional swings, 1 harness swing, and 1 parent/toddler combination swing
- Expanded the playground by an additional 475 square feet to accommodate the swings



